

# AQUARISE® PRODUCT SELECTION GUIDE

The following is a list of pipe, fittings, valves and accessories currently offered.

Nominal pipe size (Inches)	Product Code
<b>AquaRise SDR11</b> Pipe 10 Ft. Lengths, Plain End	
1/2	119000
3/4	119001
1	119002
1-1/4	119003
1-1/2	119004
2	119005
2-1/2	119009
3	119010
4	119011

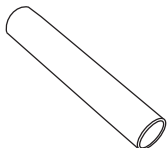

## Tee Soc x Soc x Soc

1/2	359481
3/4	359482
1	359483
1-1/4	359484
1-1/2	359485
2	359486
2-1/2	359487
3	359488
4	359489

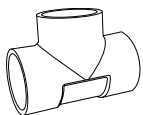

## Reducing Tee Soc x Soc x Soc

3/4 x 1/2 x 1/2	359514
3/4 x 1/2 x 3/4	359513
3/4 x 3/4 x 1/2	359492
1 x 1 x 1/2	359493
1 x 1 x 3/4	359494
1-1/4 x 1-1/4 x 1	359495
1-1/2 x 1-1/2 x 1/2	359515
1-1/2 x 1-1/2 x 3/4	359496
1-1/2 x 1-1/2 x 1	359497
2 x 2 x 1/2	359498
2 x 2 x 3/4	359499
2 x 2 x 1	359500
2 x 2 x 1-1/2	359501
2-1/2 x 2-1/2 x 1/2	359503
2-1/2 x 2-1/2 x 3/4	359504
2-1/2 x 2-1/2 x 1	359505
2-1/2 x 2-1/2 x 1-1/4	359506
2-1/2 x 2-1/2 x 2	359507
3 x 3 x 2	359502
4 x 4 x 2	359508
4 x 4 x 3	359509

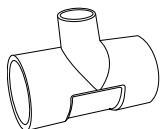

## Nominal pipe size (Inches)

## Product Code

## 45° Elbow Soc x Soc

1/2	359164
3/4	359165
1	359166
1-1/4	359167
1-1/2	359168
2	359169
2-1/2	359170
3	359171
4	359172



## 90° Elbow Soc x Soc

1/2	359194
3/4	359195
1	359196
1-1/4	359197
1-1/2	359198
2	359199
2-1/2	359200
3	359201
4	359202



## 90° Street Elbow Soc x Sp

1/2	359175
3/4	359176
1	359177



## Coupling Soc x Soc

1/2	359132
3/4	359133
1	359134
1-1/4	359135
1-1/2	359136
2	359137
2-1/2	359138
3	359139
4	359140

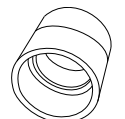

## Maintenance Coupling\*

1	359204
1-1/4	359205
1-1/2	359206
2	359207
2-1/2	359208
3	359209
4	359210

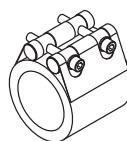

\*Torque wrench kits are available through IPEX

# AQUARISE® PRODUCT SELECTION GUIDE

	Nominal pipe size (Inches)	Product Code
<b>Reducer Coupling</b>	Soc x Soc	
	3/4 x 1/2	359460
	1 x 1/2	359461
	1 x 3/4	359462
	1-1/4 x 1	359463
	1-1/2 x 1	359465
	1-1/2 x 1-1/4	359466
	2 x 1	359467
	2 x 1-1/2	359458
	3 x 2	359470
	4 x 2	359459
	4 x 3	359472

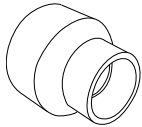

	Nominal pipe size (Inches)	Product Code
<b>Reducer Bushing</b>	Sp x Soc	
	3/4 x 1/2	359375
	1 x 1/2	359376
	1 x 3/4	359377
	1-1/4 x 1/2	359378
	1-1/4 x 3/4	359379
	1-1/4 x 1	359380
	1-1/2 x 1/2	359381
	1-1/2 x 3/4	359382
	1-1/2 x 1	359383
	1-1/2 x 1-1/4	359384
	2 x 1/2	359385
	2 x 3/4	359386
	2 x 1	359387
	2 x 1-1/4	359388
	2 x 1-1/2	359389
	2-1/2 x 3/4	359390
	2-1/2 x 1	359391
	2-1/2 x 2	359392
	3 x 1-1/2	359393
	3 x 2	359394
	3 x 2-1/2	359395
	4 x 1-1/4	359428
	4 x 1-1/2	359429
	4 x 2	359396
	4 x 2-1/2	359430
	4 x 3	359397

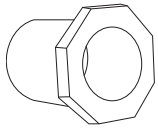

	Nominal pipe size (Inches)	Product Code
<b>Cap</b>	Soc	
	1/2	359109
	3/4	359110
	1	359111
	1-1/4	359112
	1-1/2	359113
	2	359114
	2-1/2	359115
	3	359116
	4	359107

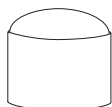

	Nominal pipe size (Inches)	Product Code
<b>Union</b>	Soc x Soc	
	1/2	359520
	3/4	359521
	1	359522
	1-1/4	359523
	1-1/2	359524
	2	359525
	3	359051
4	359550	

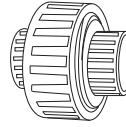

	Nominal pipe size (Inches)	Product Code
<b>Flange</b>	Soc Solid Style	
	1/2	359228
	3/4	359229
	1	359230
	1-1/4	359231
	1-1/2	359232
	2	359233
	2-1/2	359234
3	359235	
4	359236	

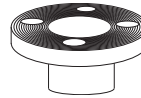

	Nominal pipe size (Inches)	Product Code
<b>Vanstone Flange</b>	Soc	
	1-1/2	359266
	2	359267
4	359270	

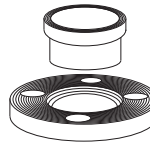

	Nominal pipe size (Inches)	Product Code
<b>Repair Flange</b>	Solid Style Flange x Pipe Stub	
	2-1/2	359057
	3	359058
	4	359059

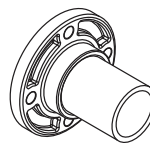

	Nominal pipe size (Inches)	Product Code
<b>Full Pressure (FP) Flange Kit</b>	2-1/2	359040
	3	359041

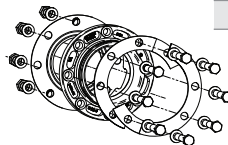

# AQUARISE® PRODUCT SELECTION GUIDE

Nominal pipe size (Inches)	Product Code
----------------------------	--------------

## True Union Ball Valve Soc x Soc

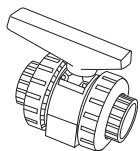

1/2	359000
3/4	359001
1	359002
1-1/4	359003
1-1/2	359004
2	359005

Rated to 232 psi @ 73°F  
Rated to 72 psi @ 160°F

## U Do-It Manifold Soc x Sp x Soc

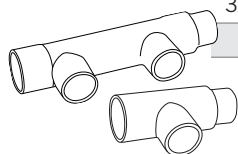

3/4 x 3/4 x 1/2 x 1/2	359060
3/4 x 3/4 x 1/2	359061

## Deburring Tools

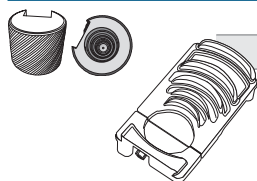

1/2, 3/4, 1	359044
1-1/4 to 4	359062

Description		Product Code
imperial	metric	

## Aquarise One-Step Cement\*\*



Pint	473 ml	359086
Quart	946 ml	359092
Gallon	3785 ml	359091

\*\*For use on 1/2" TO 2"

## Aquarise Two-Step Cement w/Primer\*\*\*



Quart	946 ml	359087
Gallon	3785 ml	359093

\*\*\*For use on 2-1/2", 3" & 4"

Cement products come complete with Primer as required and extra daubers.

Nominal pipe size (Inches)	Product Code
----------------------------	--------------

## Can-Mate Daubers (with telescoping shaft)



CM-75 (pipe sizes 1/2" - 1-1/4")	074436
CM-150 (pipe sizes 1-1/2" - 3")	074437

## Cap Daubers



DP 50 (pipe sizes 1/2" - 1")	074455
DP 150 (pipe sizes 1-1/4" - 3")	074421
DQ 50 (pipe sizes 1/2" - 1")	074193
DQ 150 (pipe sizes 1-1/4" - 3")	074422

Note: DP fits Pint cans and DQ fits Quart cans

## Swab

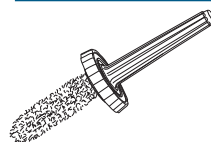

4"	074456
----	--------

## Aquarise Superswab Replacement

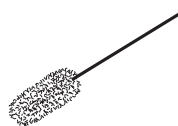

Swab is disposable and replaceable	359826
------------------------------------	--------